

5/240 Bay Street Brighton VIC

4 

First Floor

Quality fitted partitioned offices, your own separate heating and cooling, staff and kitchen amenities provided, 4 security basement car parks.
145sqm approx.

Building Size : 145 sqm

View : <https://www.mooreco.com.au/lease/vic/bayside/brighton/commercial/offices/7483865>



David Evans
03 9596 6988

1ST FLOOR, SUITE 5, 240 BAY STREET, BRIGHTON

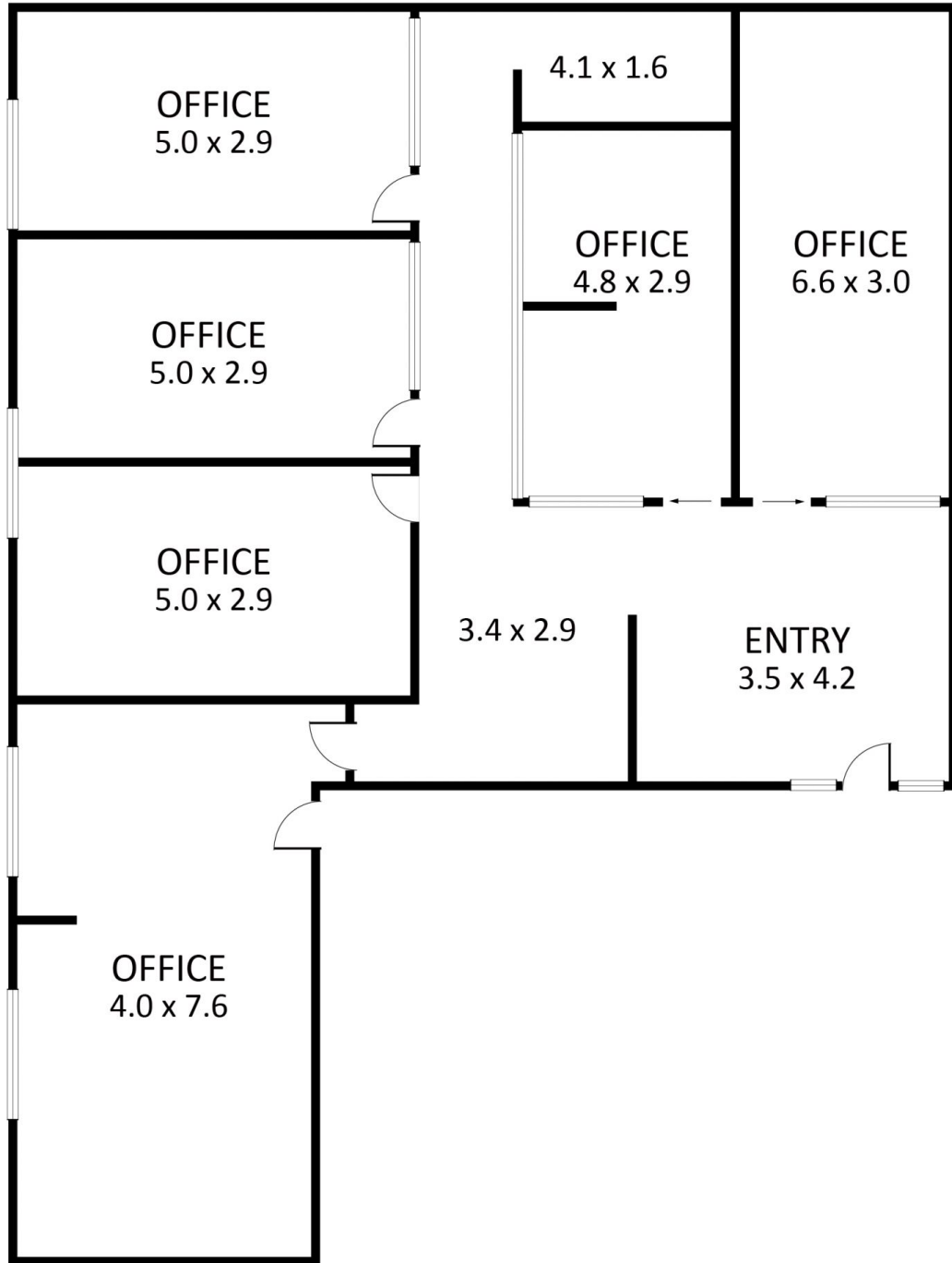

TOTAL INTERNAL AREA: 147.5 SQM APPROXI.